

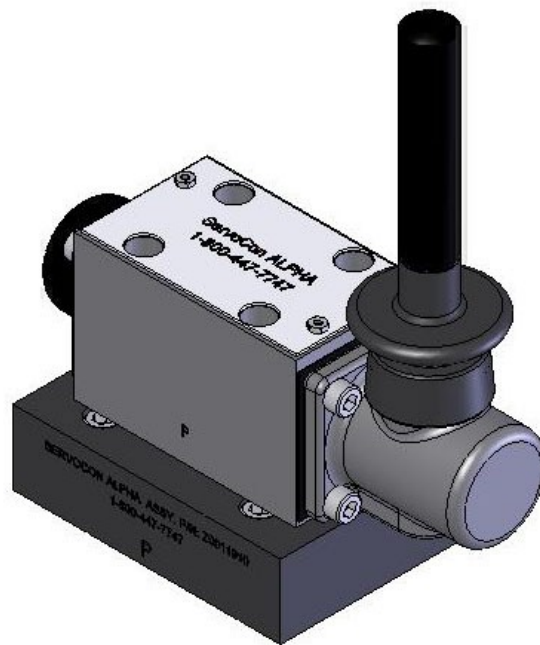

Z0011000



Flushing Valves



Hydraulic Products

- Supply
- Manufacture
- Service
- Repair



A Virginia Corporation since 1979, ServoCon's modern laboratory facilities are located in the heart of the beautiful Shenandoah Valley. A Virginia Corporation since 1989, ALPHA engineering design, production and new parts distribution facilities have teamed up with ServoCon to provide all of your fluid power controls, sales new from ALPHA and service from ServoCon.

For two decades ServoCon and ALPHA engineers, technicians, sales and support staff have been providing the industry's highest quality sales and service in fluid power components. ServoCon ALPHA is an ISO 9001-2000 compliant global leader selling and repairing electrohydraulic servocontrols for power generation facilities. We have qualified engineers and technicians, calibrated test equipment, static and dynamic testing at the component and assembly level, large replacement parts inventory, competitive pricing and quick turn around. Our engineers and technicians have been trained by major OEMs. With over 30 years of experience, our staff can best provide for your repair or new servoactuator and servovalve needs.

•
WE OFFER NEW

•
COMPONENTS FOR ANY APPLICATION

•
ALL REPAIR WORK COMES WITH "AS NEW WARRANTY"

•
LET OUR PROFESSIONAL TECHNICAL STAFF PROVIDE YOU WITH OVER 30 YEARS OF EXPERIENCE "WE KNOW THE DESIGNS OF THE QUALITY COMPONENTS BECAUSE WE HAVE BEEN REPAIRING THEM ALL FOR YEARS"

•
QUICK TURNAROUND

•
To Order Call: 1-800-447-7747

Table of Contents

Table of Contents	1
Flushing Valve Overview	2
Components	3
Repair Procedure	4
Components of Reheat Stop Control Pac	5

The text and images contained within are © 2010 (all rights reserved) by ServoCon Associates Inc. and ALPHA Development Bureau, Inc 167 Expo Road Fishersville, Virginia 22939 Phone: (540) 337-4900 FAX: (540) 337-4901

To Order Call: 1-800-447-7747

Flushing Valves

Operation

The amount of contaminant removed during a flushing depends not only on the effectiveness of the filter used, but also the velocity of the flushing fluid. Unless high velocities are attained, much of the contaminant will not be dislodged. The flushing valve designed and made by Servocon ALPHA can be installed in place of the servovalve to test the hydraulics. Normal operation of the flushing valve immediately shows if the system is operating properly. The valve is designed for easy flushing. It has a tandem center so that the pressure port has a connection to the tank. With the pump running and the valve centered, the hydraulic system will flush by circulating oil through the pressure, return lines and through the system filters. Both sides of the actuator and its lines are flushed by moving the handle forward and back. Where applicable the flushing valve has a fifth port for flushing systems with fifth port valves. While the system is being flushed the servovalve is protected from fluid contamination.

Assembly

The principal components of the Z0011920 flushing valve assembly is the Z0011910 flushing valve and the Z011921 and Z011922 manifold.

Z0011910 Flushing Valve

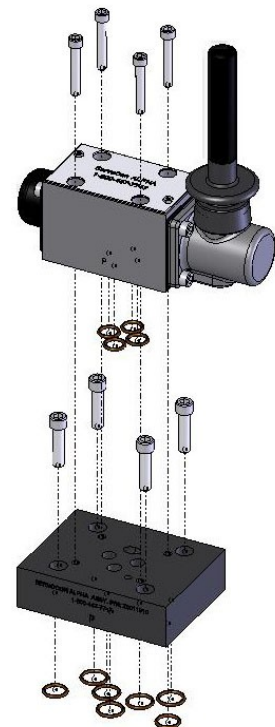

Components

Manifold Blocks

In order to adapt the flushing valves to the hydraulic system and the control pac, we provide many different types of manifolds. Z0011920 flushing valves replace Valves through the use of the Z-11921 and Z011922 manifolds.

Z011921 Manifold

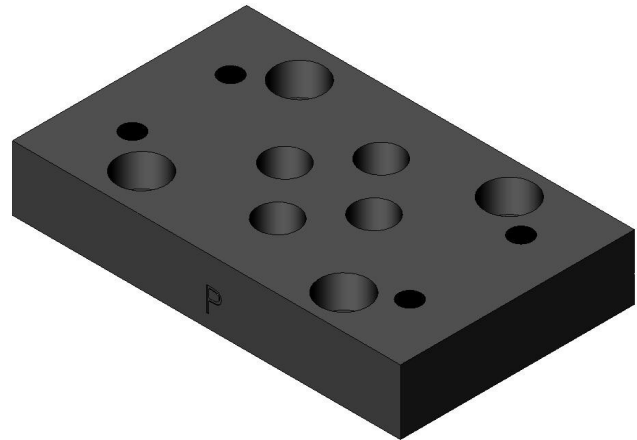

Z011922 Manifold

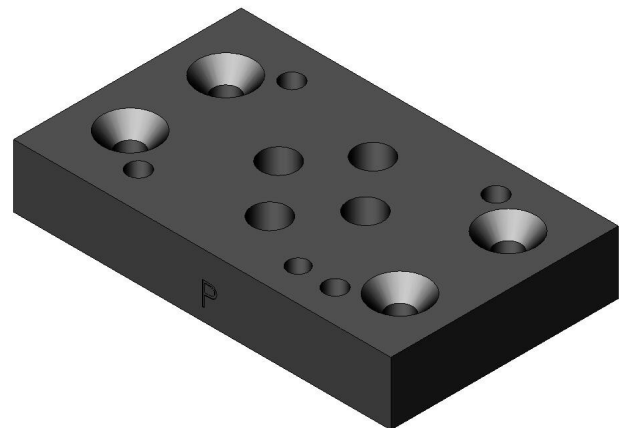

Repair Procedure

Steps Of Our Repair Procedure

1. We receive Flushing Valves into our lab.
2. Each Flushing Valve is visually inspected and any outward condition is noted by our receiving inspector.
3. All components are marked for identification so that the same components stay with the correct Flushing valve.
4. All components are removed and disassembled individually and cleaned. Any contamination found in components will be documented for your review and our customer records.
5. Seals are replaced on all components. Pricing for these will be sent to you on a price approval sheet prior to doing any work.
6. All components, including the cylinder, are re-assembled and tested to OEM specifications. The Flushing valves are tested through a "burn-in test" where they are actuated with system pressure. Internal leakages are checked and individual components are evaluated for minimum leakage requirements.
7. When there are no signs of external leakage, the unit is prepared for safe shipment back to the customer.
8. There will be a detailed service report for all flushing valves sent to the I & C Supervisor. Communication between ServoCon's technicians and the customer is frequent.
9. Nothing beyond the scope of Cleaning & Calibration will be done without prior notice and/or price approval using our authorization procedure.
10. We require that the customer remove fluid prior to shipment. There will be a charge for fluid removal and disposal.

Control Pacs

Governor Control Pacs
Z0153000

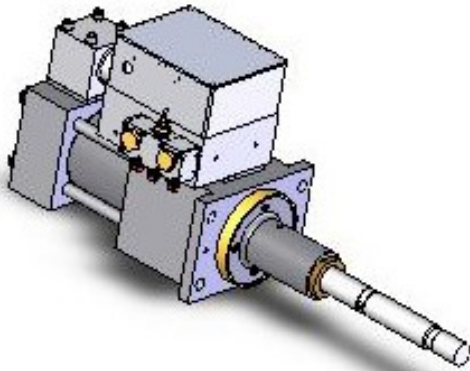

Throttle Control Pacs
Z0158000

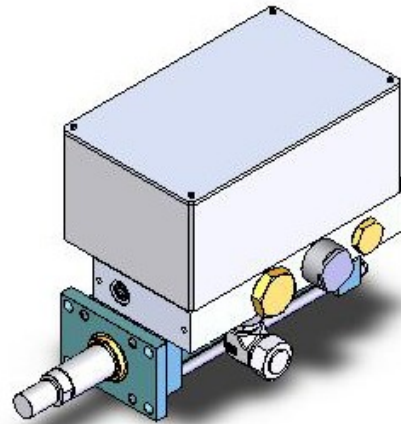

Intercept Control Pacs

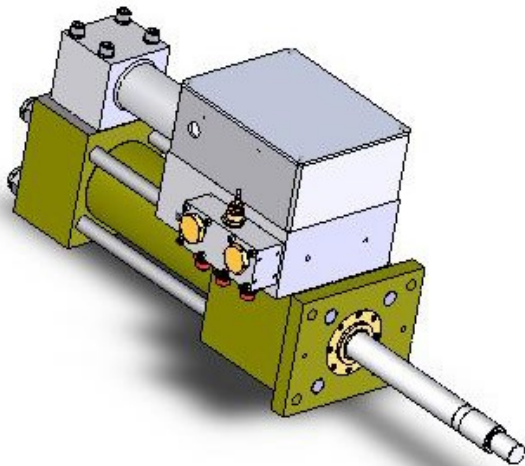

ServoCon[®] ALPHA



ServoCon ALPHA

Expo Industrial Park

167 Expo Road

Fishersville, VA 22939

Phone: 800-447-7747

Fax: 540-337-4901

Email:

servoconalpha@servoconalpha.com

<http://www.servoconalpha.com>